



MEEVER & MEEVER



CHARACTERISTIC OF THE SYSTEM:

- Allows to support BRACE 300 and BRACE 400 systems with **1000 kN SWL** (Safe Working Load – designed for 1500 kN – declared 1000 kN axial capacity)
- Maximum sheet to sheet span by 1000 kN SWL – 14 meters
- rough adjuster stroke 650mm
- prestressing/residual force release ending 100mm stroke
- fixed length extensions 0.5m, 1.0m, 2.0m, 3.0m and 5.0m
- might be operated with hydraulic pump delivered with BRCAE 300 or BRACE 400 or with hand operated pump
- might be operated with 500 kN jack delivered with BRACE 300 (than max capacity is 500 kN), 1200 kN jack delivered with BRACE 400 or with dedicated 1000 kN hydraulic jack
- construction welded acc. EN1090 – certified factory

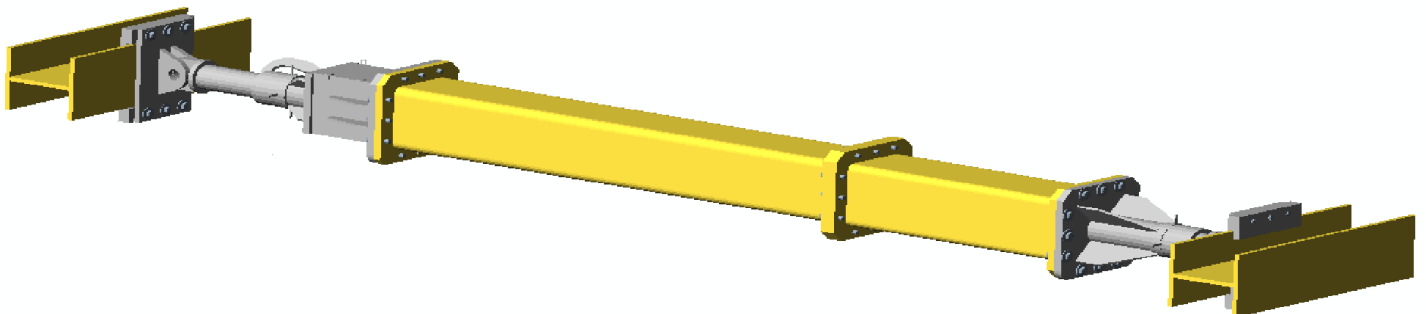

GORINCHEMSESTRAAT 37 | 4231 BE MEERKERK | THE NETHERLANDS

T: +31 183 358 383 | F: +31 183 358 380 | E: INFO@MEEVER.NL | WWW.MEEVER.NL